



SOFT FOIL

SILVER BLACK / SF-2002(PE)

PRODUCT INFORMATION

Double side poly woven bonded with fire retardant adhesive to the aluminium foil. Also our double side poly woven has durable water proof surface and vapour control layer, high emittance.

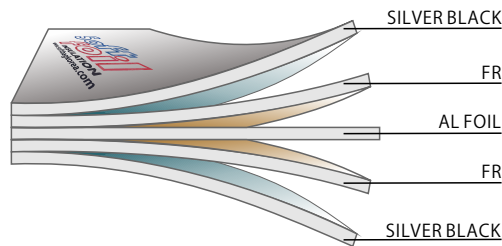
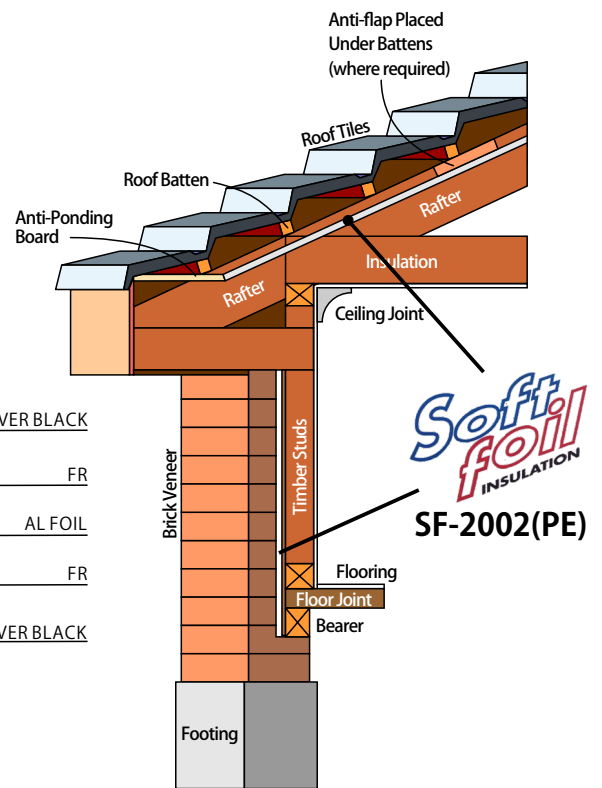
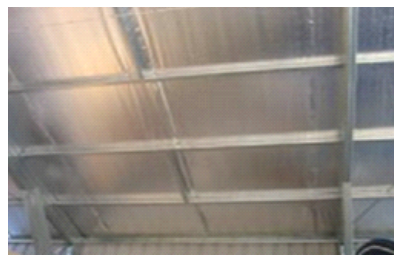

click to
MSDS

**SOFT
FOIL
SILVER
BLACK
SF-2002(PE)**



PHYSICAL CHARACTERISTICS

Description	Parameter	Test Method
Emissivity	0.03	ASTM E408
Water resistance	>200mm	AATCC 127
Flammability index	<5	AS 1530.2
Tensile strength Machine Direction	>10.5 kN/m	ASTM D4595
Tensile strength Lateral Direction	>9.5 kN/m	
Edge tear resistance	90	TAPPI T470
Air barrier	High	
Shrinkage	<2%	AS 1736(AS/NZS 4201.3)
Width : 1350mm / 1500mm		
Color : Silver Black		
Weight : 210GSM		

SOFTBAG KOREA CO.,LTD.

6FL, Shingang Bldg,
67, Seongsui-ro,
Seongdong-gu,
Seoul, KOREA

Tel. 82-2-462-1401

Fax. 82-2-462-1402

Email: kenny@softbagkorea.com

click to
Contact us