



# SOFT FOIL

## SUPER LIGHT DUTY SF-9005

### PRODUCT INFORMATION

Our specialized manufacturing process bonds together Al-foil to the high strength reinforcing polymer mesh using a flame retardant adhesive. Our reinforcing poly-mesh is treated colors to reduced reflective glare problems when soft foil is insulated.

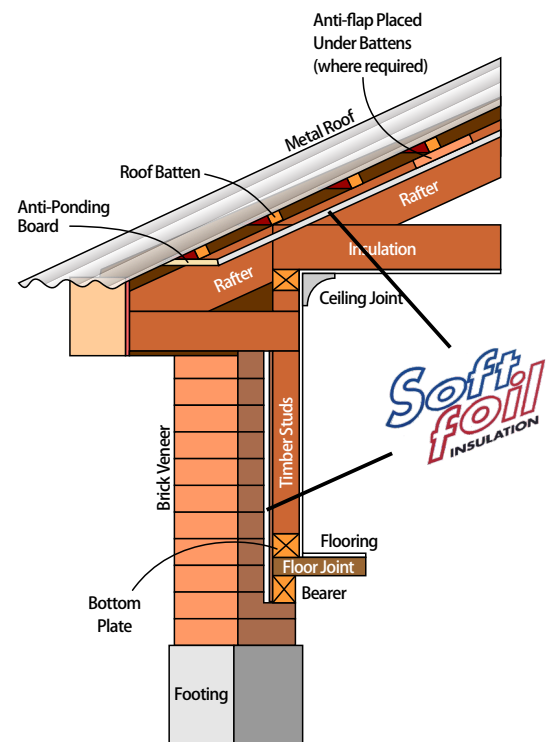
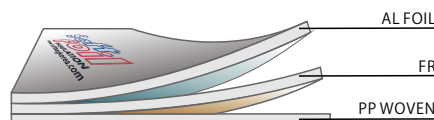
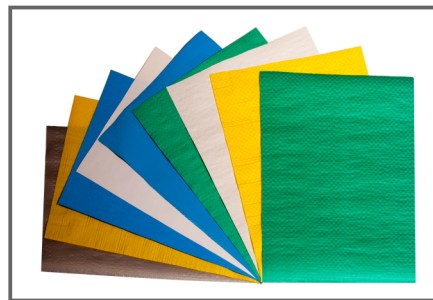
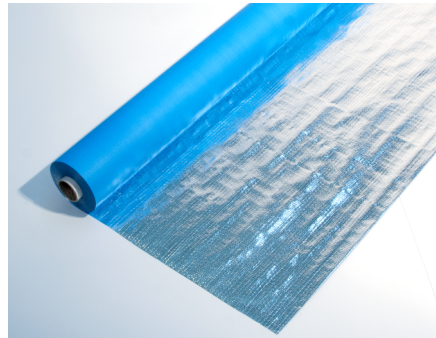

click to  
MSDS

**SOFT  
FOIL  
SUPER  
LIGHT DUTY  
SF-9005**



### PHYSICAL CHARACTERISTICS

Description	Parameter	Test Method
Duty	Super Light	AS 1301.448
Reflectivity	97%	AS 4201.5
Emissivity	0.03	ASTM E408
Water penetration	Pass	
Flammability index	<5	AS 1530.2
Tensile strength Machine Direction	10kN/m	ASTM D4595
Tensile strength Lateral Direction	8kN/m	
Edge tear resistance Machine Direction	70N	TAPPI T470
Edge tear resistance Lateral Direction	70N	
Shrinkage	<1.4%	AS 1736 (AS/NZS 4201.3)
Bonding strength poly to foil	>100N/25mm	
Width : 1200mm ~1600mm		
Color : Sky Blue, Dark Blue, Green, White, Silver Grey		
Weight : 85 ± 5GSM		

SOFTBAG KOREA CO.,LTD.

6FL, Shingang Bldg,  
67, Seongsui-ro,  
Seongdong-gu,  
Seoul, KOREA  
Tel. 82-2-462-1401  
Fax. 82-2-462-1402

Email: kenny@softbagkorea.com

click to  
Contact us