



SOFT FOIL

HEAVY DUTY SF-3001

PRODUCT INFORMATION

Our specialized manufacturing process bonds together Al-foil to the high strength reinforcing polymer mesh using a flame retardant adhesive. Our reinforcing poly-mesh is treated extruder coating to increase bond power to next process (on foam, glass wool, poly material)

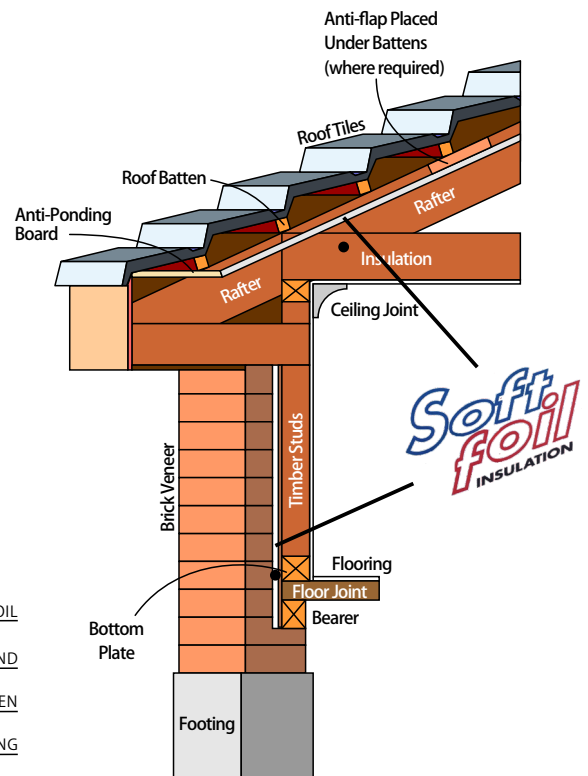
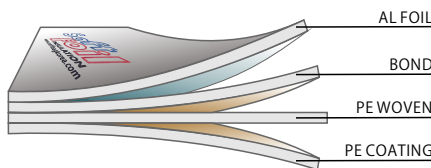
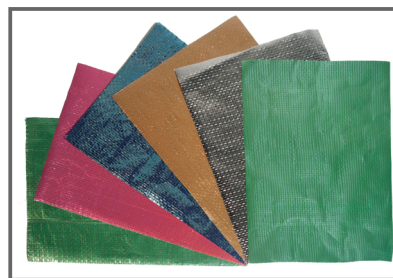
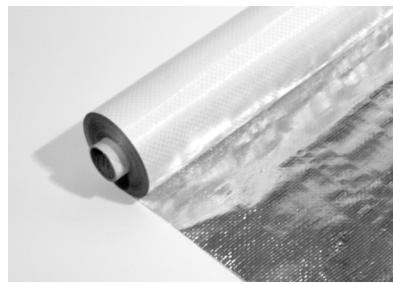

click to
MSDS

SOFT FOIL

HEAVY DUTY SF-3001



SOFTBAG KOREA CO.,LTD.

6FL, Shingang Bldg,
67, Seongsui-ro,
Seongdong-gu,
Seoul, KOREA

Tel. 82-2-462-1401

Fax. 82-2-462-1402

Email: kenny@softbagkorea.com

click to
Contact us

PHYSICAL CHARACTERISTICS

Description	Parameter	Test Method
Duty	Heavy	AS 1301.448
Reflectivity	97%	AS/NZS 4201.5
Emissivity	0.03	ASTM E408
Water barrier	High	AS 1736 (AS/NZS 4201.4)
Flammability index	<5	AS 1530.2
Tensile strength Machine Direction	650~700N/5cm	ASTM D4595
Tensile strength Lateral Direction	550~600N/5cm	
Edge tear resistance Machine Direction	90N	TAPPI T470
Edge tear resistance Lateral Direction	90N	
Water vapour transmission rate	Low Ng/Ns	ASTM E96
Elongation	MD: 10~20 CD: 10~20	ASTM D4595
Bonding strength poly to foil	>100N/25mm	
Width : 1380 / 1530mm		
Color : Glare (Al-side)		
Weight : 130±5GSM		