



SOFT FOIL

EXTRA HEAVY DUTY SF-9001

PRODUCT INFORMATION

Our specialized manufacturing process bonds together Al-foil to the high strength reinforcing polymer mesh using a flame retardant adhesive. Our reinforcing poly-mesh is treated colors to reduced reflective glare problems when soft foil is insulated.

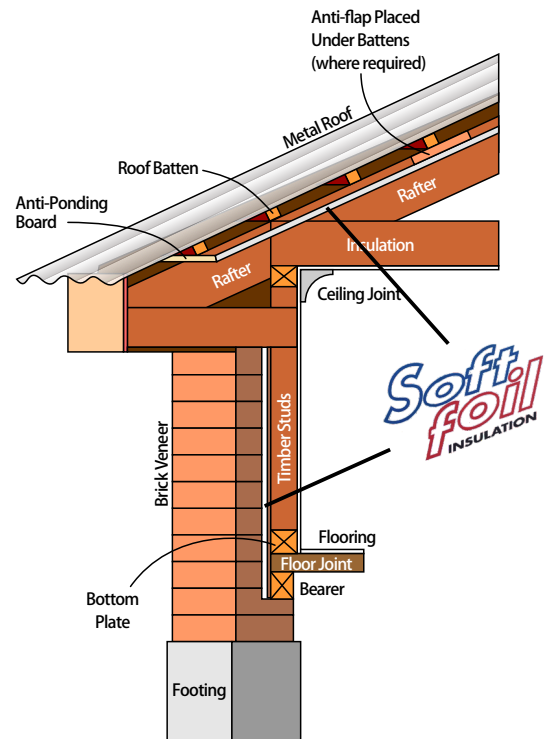
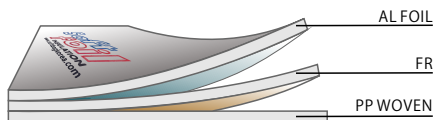
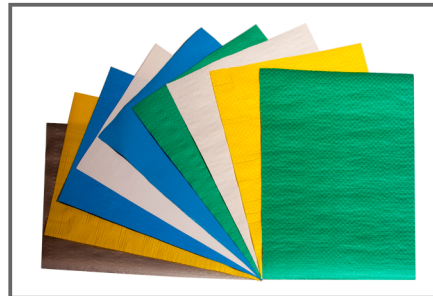
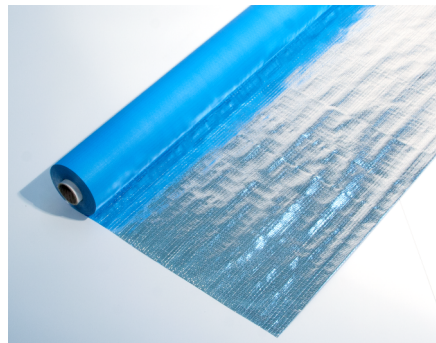

click to
MSDS

**SOFT
FOIL
EXTRA
HEAVY DUTY
SF-9001**



PHYSICAL CHARACTERISTICS

Description	Parameter	Test Method
Duty	Extra Heavy	AS 1301.448
Reflectivity	97%	AS 4201.5
Emissivity	0.03	ASTM E408
Water penetration	Pass	
Flammability index	<5	AS 1530.2
Tensile strength Machine Direction	19.82kN/m	ASTM D4595
Tensile strength Lateral Direction	19.85kN/m	
Edge tear resistance Machine Direction	80N	TAPPI T470
Edge tear resistance Lateral Direction	80N	
Shrinkage	<0.5%	AS 1736 (AS/NZS 4201.3)
Width : 1200mm ~1600mm		
Color : Sky Blue, Dark Blue, Green, White, Silver Grey		
Weight : 170±5GSM		

SOFTBAG KOREA CO.,LTD.

6FL, Shingang Bldg,
67, Seongsui-ro,
Seongdong-gu,
Seoul, KOREA
Tel. 82-2-462-1401
Fax. 82-2-462-1402

Email: kenny@softbagkorea.com

click to
Contact us