



SOFT FOIL

MEDIUM DUTY SF-3002

PRODUCT INFORMATION

Our specialized manufacturing process bonds together Al-foil to the high strength reinforcing polymer mesh using a flame retardant adhesive. Our reinforcing poly-mesh is treated extruder coating to increase bond power to next process (on foam, glass wool, poly material)

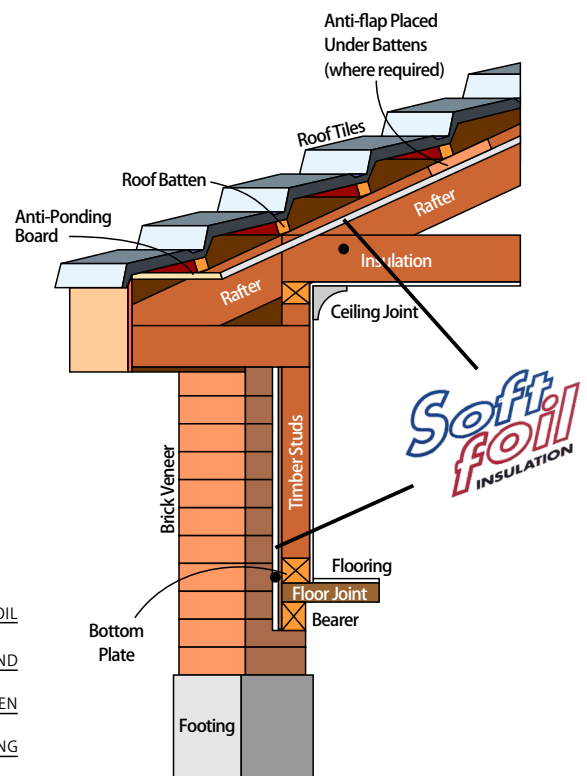
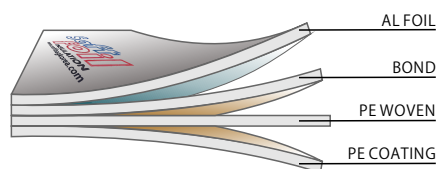
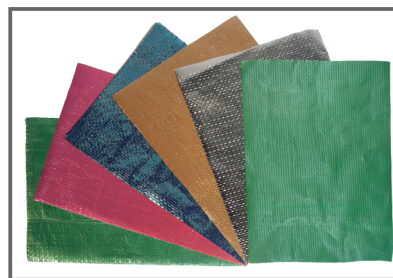
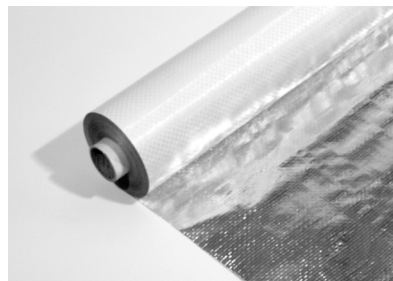

click to
MSDS

SOFT FOIL

MEDIUM DUTY SF-3002



PHYSICAL CHARACTERISTICS

| Description | Parameter | Test Method |
|-------------------------------------------------|---------------------|-------------------------|
| Duty | Medium | AS 1301.448 |
| Reflectivity | 97% | AS/NZS 4201.5 |
| Emissivity | 0.03 | ASTM E408 |
| Water barrier | High | AS 1736 (AS/NZS 4201.4) |
| Flammability index | <5 | AS 1530.2 |
| Tensile strength Machine Direction | 550~650N/5cm | ASTM D4595 |
| Tensile strength Lateral Direction | 450~550N/5cm | |
| Edge tear resistance Machine Direction | 70N | TAPPI T470 |
| Edge tear resistance Lateral Direction | 70N | |
| Water vapour transmission rate | Low Ng/Ns | ASTM E96 |
| Elongation | MD: 20~30 CD: 20~30 | ASTM D4595 |
| Bonding strength poly to foil | >100N/25mm | |
| Width : 1380 / 1530mm | | |
| Color : Glare and Anti-glare (Red, Blue, Green) | | |
| Weight : 120±5GSM | | |

click to
Contact us

SOFTBAG KOREA CO.,LTD.

6FL, Shingang Bldg,
67, Seongsui-ro,
Seongdong-gu,
Seoul, KOREA
Tel. 82-2-462-1401
Fax. 82-2-462-1402

Email: kenny@softbagkorea.com