



SOFT FOIL

MEDIUM DUTY SF-9003

PRODUCT INFORMATION

Our specialized manufacturing process bonds together Al-foil to the high strength reinforcing polymer mesh using a flame retardant adhesive. Our reinforcing poly-mesh is treated colors to reduced reflective glare problems when soft foil is insulated.

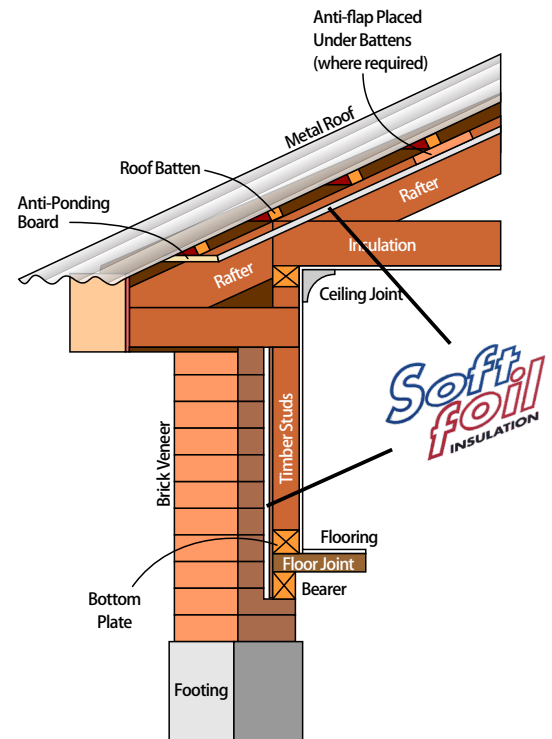
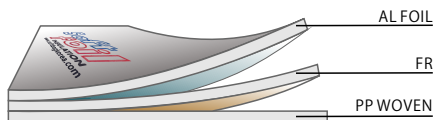
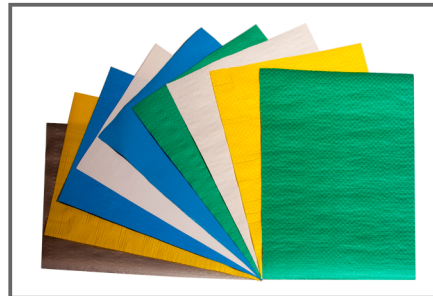
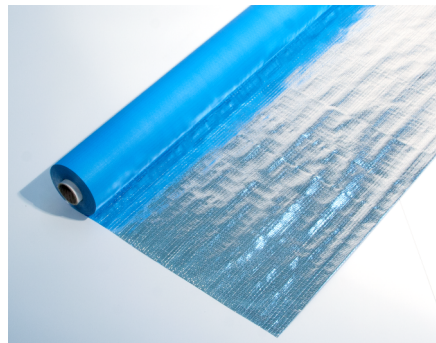

click to
MSDS

SOFT FOIL

MEDIUM DUTY SF-9003



PHYSICAL CHARACTERISTICS		
Description	Parameter	Test Method
Duty	Medium	AS 1301.448
Reflectivity	97%	AS 4201.5
Emissivity	0.03	ASTM E408
Water penetration	Pass	
Flammability index	<5	AS 1530.2
Tensile strength Machine Direction	11.8kN/m	ASTM D4595
Tensile strength Lateral Direction	10.8kN/m	
Edge tear resistance Machine Direction	80N	TAPPI T470
Edge tear resistance Lateral Direction	80N	
Shrinkage	<1.2%	AS 1736 (AS/NZS 4201.3)
Width : 1200mm ~1600mm		
Color : Sky Blue, Dark Blue, Green, White, Silver Grey		
Weight : 110±5GSM		

SOFTBAG KOREA CO.,LTD.
 6FL, Shingang Bldg,
 67, Seongsui-ro,
 Seongdong-gu,
 Seoul, KOREA
 Tel. 82-2-462-1401
 Fax. 82-2-462-1402
 Email: kenny@softbagkorea.com

click to
Contact us